



CEDAR  **RUN**
apartments

CEDAR RUN

apartments

Cedar Run's superb Cherry Creek location is convenient to the city's finest shopping, restaurants and recreation. The community offers spacious apartment homes, beautiful landscaping which includes spectacular fountains and ponds as well as a full range of amenities.

You can enjoy an unparalleled state-of-the-art fitness center as well as racquetball, swimming, volleyball or jogging and bicycling along



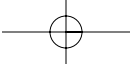

nearby paths. Experience why Cedar Run is southeast Denver's first choice in apartment living.

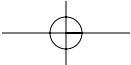

1 Bedroom/ 1 Bath
672-793 Square Feet*

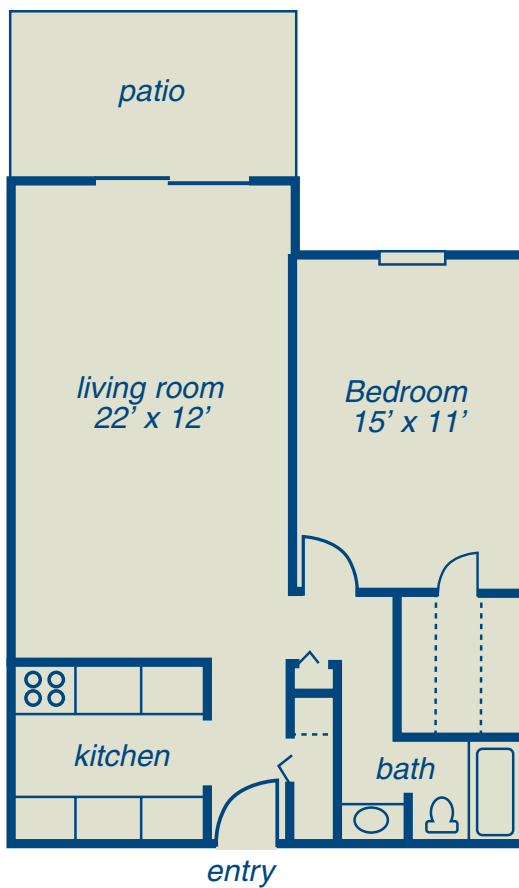

\$ _____

*Floorplans vary based on square footage

The community offers spacious apartment homes

2 Bedroom/ 2 Bath
980-1120 Square Feet*

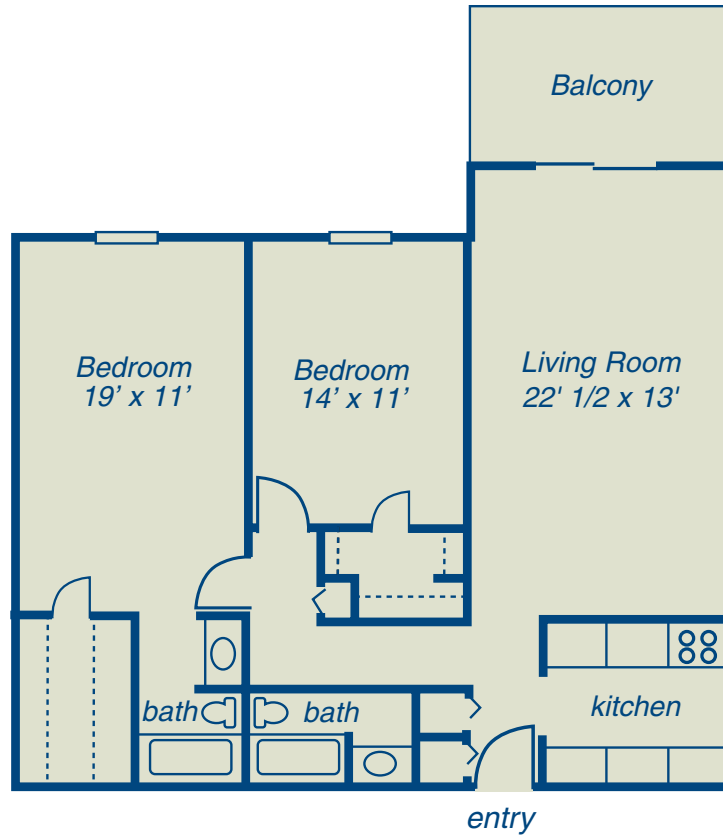

\$ _____

**Floorplans vary based on square footage*

Convenient to finest shopping and restaurants

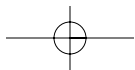
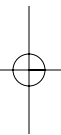
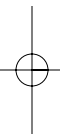
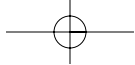

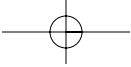

CEDAR RUN APARTMENT FEATURES

- ▶ Clubhouse
- ▶ State Of The Art Fitness Center
- ▶ 2 x Indoor Racquetball Courts
- ▶ Half Basketball Court
- ▶ Indoor Jacuzzi
- ▶ Indoor Heated Swimming Pool
- ▶ 2 x Outdoor Heated Swimming Pools
- ▶ Business Center With High Speed Internet Access
- ▶ Outdoor Volleyball Sandpit
- ▶ Children's Outdoor Play Area
- ▶ 2 x Community Courtyards With BBQ Grilles
- ▶ Covered Parking Areas
- ▶ Beautiful Mature Landscaping With Ponds & Fountains
- ▶ Huge 1 & 2 Bedroom Floor plans
- ▶ Oversized Private Balconies
- ▶ Spacious Walk-in Closets
- ▶ Laundry Facilities & Elevators In Every Building
- ▶ Fireplaces In Select Apartment Homes
- ▶ Pet Friendly Community
- ▶ 24-Hour Emergency Maintenance
- ▶ Walking Distance To Grocery Stores & Banks
- ▶ Convenient To Local Restaurants
- ▶ Minutes To Downtown & Cherry Creek Shopping
- ▶ A Staff That Is Dedicated To Providing The Best Customer Service In The Neighborhood

CEDAR RUN
apartments

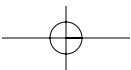
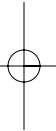



Cedar Run Apartments

888 South Onedia
 Denver, Colorado 80224
 303-399-0526
 FAX: 303-393-8522

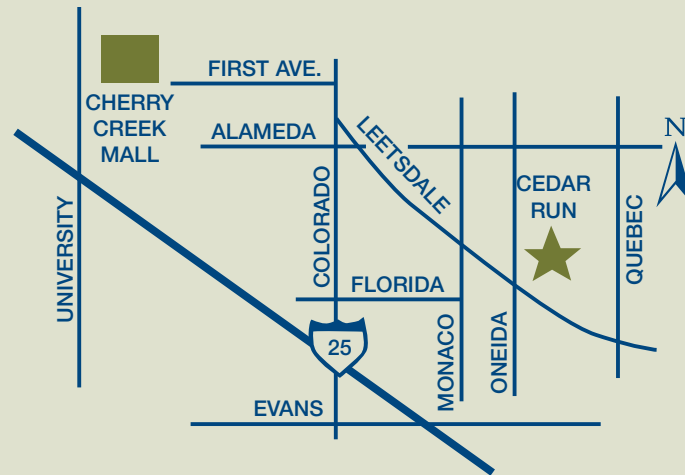

Directions: From I-25, exit Colorado Blvd going north.
 At Florida Ave., travel east to Monaco St. Go north on Monaco to
 Leetsdale then turn east. Go approximately 1/4 mile to South Oneida
 and turn north. Cedar Run entrance is immediately on your right.